

# Ports Configuration

## Compact

The below numbers should be used inside the Configurator when using one of the ports on the Compact:

- **RS-232 (DB9)**: use 0.
- **USB**: use 10.

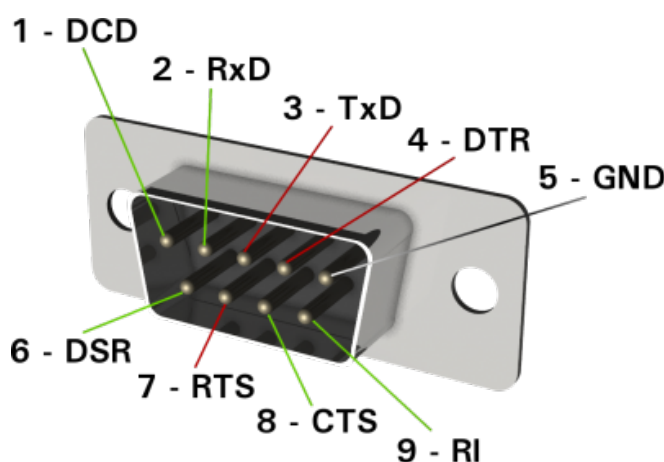

| Pin | Signal | Name                | Type   |
|-----|--------|---------------------|--------|
| 1   | DCD    | Data Carrier Detect | Input  |
| 2   | RxD    | Receive Data        | Input  |
| 3   | TxD    | Transmit Data       | Output |
| 4   | DTR    | Data Terminal Ready | Output |
| 5   | GND    | Signal Ground       | -      |
| 6   | DSR    | Data Set Ready      | Input  |
| 7   | RTS    | Request to Send     | Output |
| 8   | CTS    | Clear to Send       | Input  |
| 9   | RI     | Ring Indicator      | Input  |

Compact's DB9 Serial Port

## Rack

The below numbers should be used inside the Configurator when using one of the ports on the Rack:

- **RS-232 (DB9) x2**: use 0 and 1. Consult the Compact's image for reference.
- **Additional green ports (RS-232 and RS-485)**: use 2 and 3.
- **USB**: use 10.

The additional green ports on the Rack can be used either for RS-232 or RS-485. Consult the picture below for a proper connection.

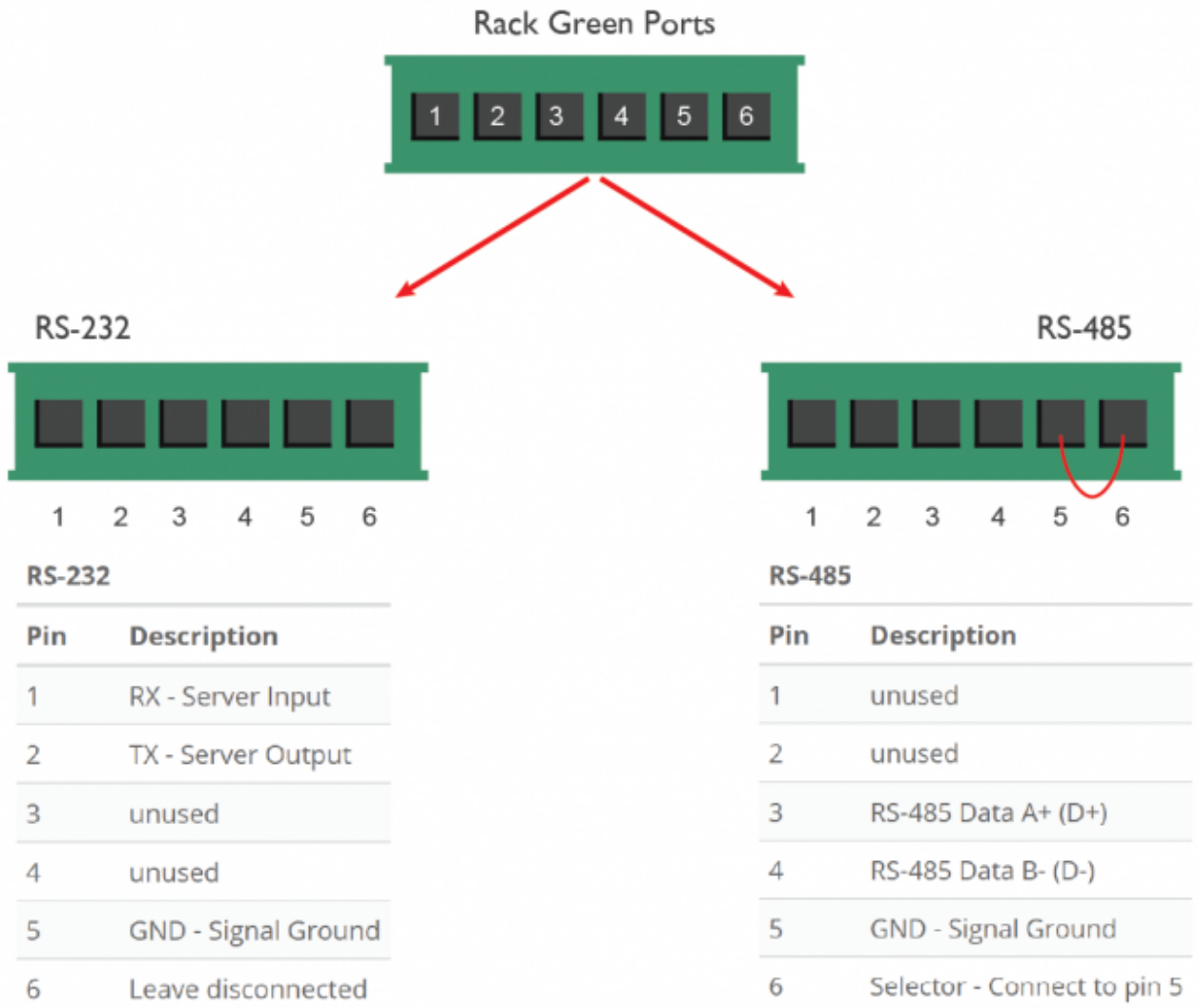

Rack's Green Ports

## Brickbox

The below numbers should be used inside the Configurator when using one of the ports on the Brickbox:

- **RS-232:** use 4.
- **RS-485:** use 5.

Brickbox's Ports

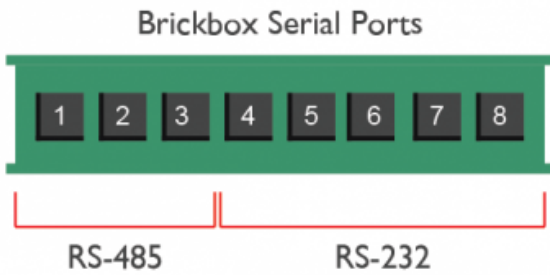

| RS-485 |              | RS-232 |                                |
|--------|--------------|--------|--------------------------------|
| Pin    | Description  | Pin    | Description                    |
| 1      | GND - Ground | 4      | GND - Ground                   |
| 2      | Data A (D+)  | 5      | CTS - Clear To Send (input)    |
| 3      | Data B (D-)  | 6      | RTS - Request To Send (output) |
|        |              | 7      | RX - Receive Data (input)      |
|        |              | 8      | TX - Transmit Data (output)    |

## Envision\_20

The below numbers should be used inside the Configurator when using one of the ports on the Envision\_20:

- **RS-232:** use 1.
- **RS-485:** use 2.
- **USB:** use 10.

Envision's Ports

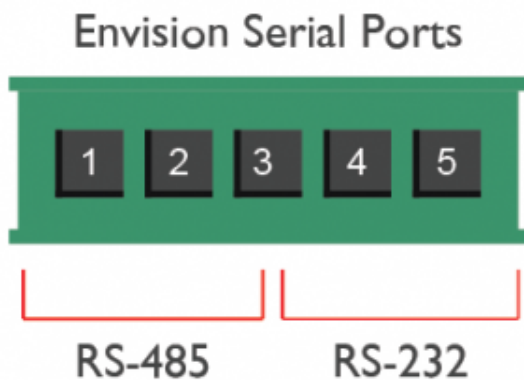

| RS-485 |             | RS-232 |                             |
|--------|-------------|--------|-----------------------------|
| Pin    | Description | Pin    | Description                 |
| 1      | Data A (D+) | 3      | GND - Ground                |
| 2      | Data B (D-) | 4      | TX - Transmit Data (output) |
|        |             | 5      | RX - Receive Data (input)   |

## Compact\_20

The below numbers should be used inside the Configurator when using one of the ports on the Compact\_20:

- **RS-232:** use 4.
- **RS-485:** use 5.
- **USB:** use 10.

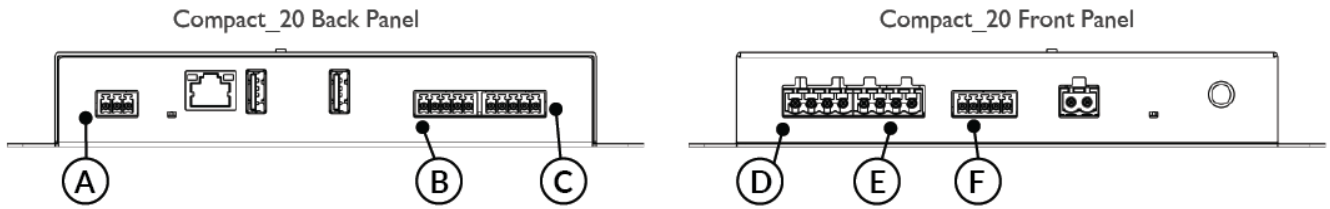

Compact\_20 Front/Back Panels

Compact\_20 RS-485

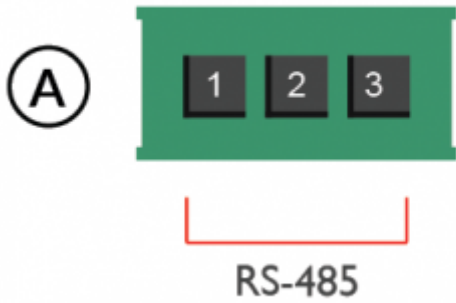

| RS-485 |              |
|--------|--------------|
| Pin    | Description  |
| 1      | Data A (D+)  |
| 2      | Data B (D-)  |
| 3      | GND - Ground |

Compact\_20 RS-232 + Digital Inputs

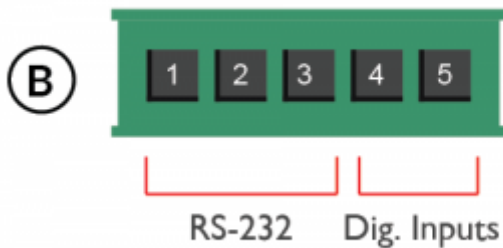

| RS-232 |                          | Dig. Inputs |             |
|--------|--------------------------|-------------|-------------|
| Pin    | Description              | Pin         | Description |
| 1      | GND - Ground             | 4           | Digital IN1 |
| 2      | RX - Receive Data (IN)   | 5           | Digital IN2 |
| 3      | TX - Transmit Data (OUT) |             |             |

Compact\_20 Analog/Digital Inputs



| Analog/Digital Inputs |             |
|-----------------------|-------------|
| Pin                   | Description |
| 1                     | Input 1     |
| 2                     | Input 2     |
| 3                     | Input 3     |
| 4                     | Input 4     |
| 5                     | Input - GND |

Compact\_20 Relays 1-2

| Relays 1-2 |                |
|------------|----------------|
| Pin        | Description    |
| 1          | Common R1      |
| 2          | Relay 1 (N.O.) |

D



Relays 1-2 (6A)

| Relays 1-2 |                |
|------------|----------------|
| Pin        | Description    |
| 3          | Common R2      |
| 4          | Relay 2 (N.O.) |

Compact\_20 Relays 3-4

E



Relays 3-4 (6A)

| Relays 3-4 |                |
|------------|----------------|
| Pin        | Description    |
| 1          | Common R3      |
| 2          | Relay 3 (N.O.) |
| 3          | Common R4      |
| 4          | Relay 4 (N.O.) |

Compact\_20 Digital Outputs

F

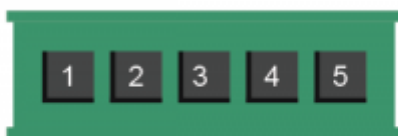

Dig. Outputs (open collector)

| Digital Outputs (open collector) |              |
|----------------------------------|--------------|
| Pin                              | Description  |
| 1                                | Supply       |
| 2                                | Output 1     |
| 3                                | Output 2     |
| 4                                | Output 3     |
| 5                                | GND - Ground |

## Micro\_20

The below numbers should be used inside the Configurator when using one of the ports on the Micro\_20:

- **USB:** use 10.

## Examples

### Connecting a DCE device with DB9

A DCE device usually has the pins TX and RX inverted (TX on pin 2, RX on pin 3).

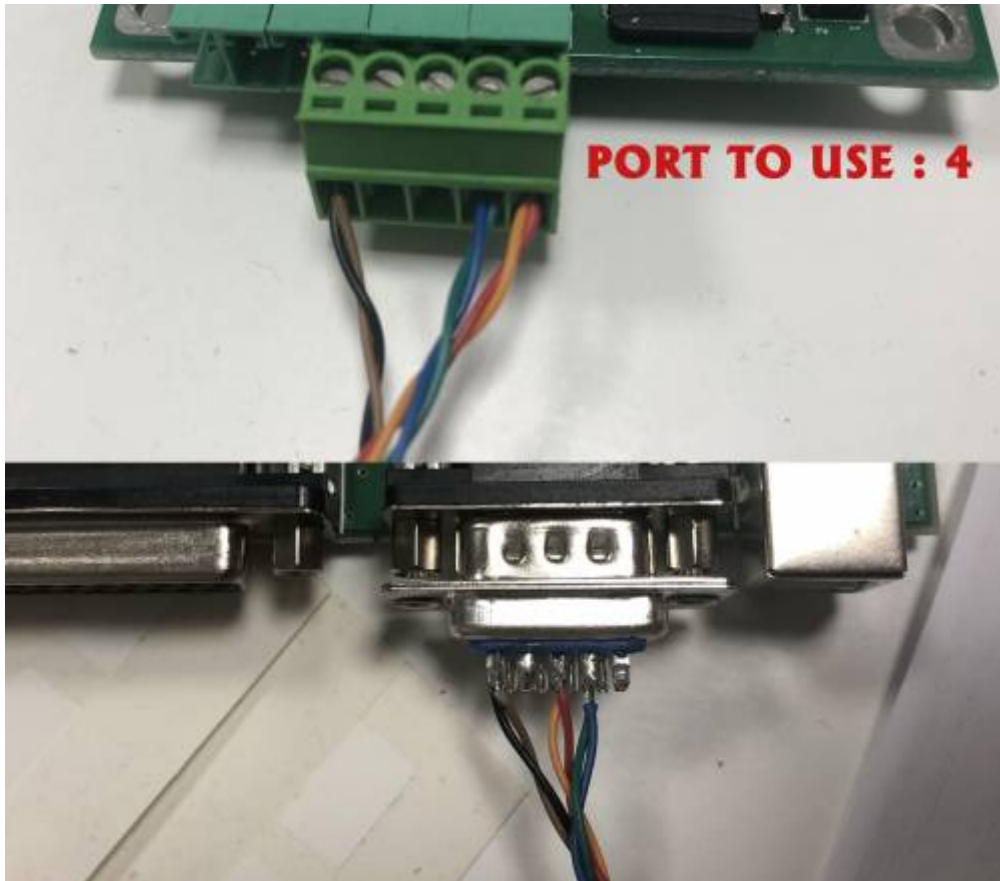

Connecting Brickbox to Paradox DB9 port

### Transforming a green block into DB9

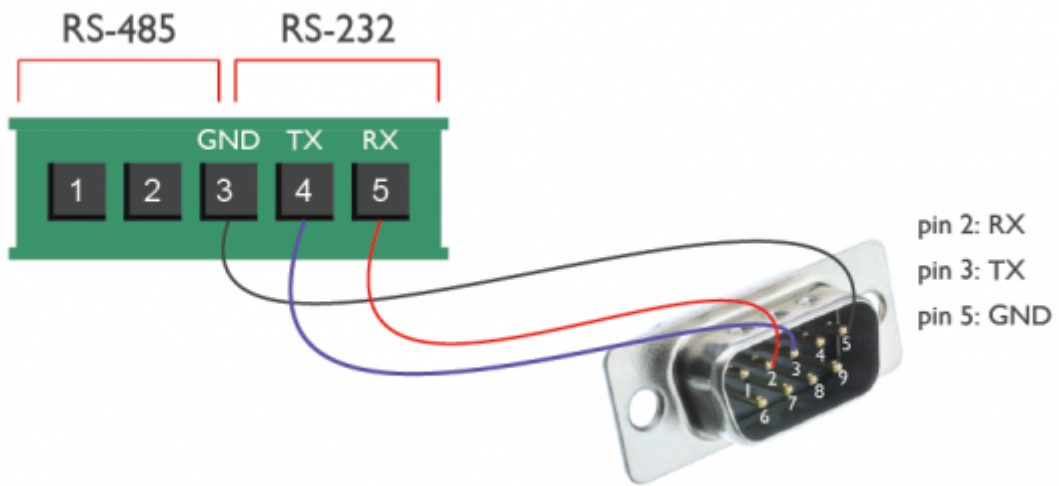

Transforming Envision port to DB9 port

From:

<https://www.thinknx.com/wiki/> - **Learning Thinknx**

Permanent link:

[https://www.thinknx.com/wiki/doku.php?id=port\\_numbers](https://www.thinknx.com/wiki/doku.php?id=port_numbers)

Last update: **2021/11/08 14:05**

